



For use with **QUADCAB®** (HSQ series), Commercial **RE-BOX®** (IDF series), and HI-Impact **RE-BOX®** (IR Series) enclosures.

## Patch Panel Mounting Bracket

Use to mount 19" patch panels to rear wall.  
Provides front access to rear for easy termination.

Contents: 2 brackets (left and right)



Rack Units	Catalog. No.
4	<b>REK19</b>
2	<b>REK19L</b>

## Equipment Mounting Bracket

Provides 19" mounting for hubs and other active equipment to rear wall.

Contents: 2 brackets (left and right)



Rack Units	Catalog. No.
5	<b>REKZ</b>
3	<b>REKZL</b>

*Note: Account for depth of equipment.*

## 3/4" Plywood Backboard

Provides universal mounting for wall mounted brackets, blocks, splitters, hubs and other devices.  
Mounts to rear wall.

Contents: 0.75" APA grade AC plywood painted fire-retardant white, 2 mounting brackets, 1 assembly hardware kit



Dimensions	RWU	Catalog. No.
20"x19"	2	<b>REKBB20</b>
30"x19"	3	<b>REKBB30</b>
40"x19"	4	<b>REKBB40</b>

## 110/66 Block Mounting Rails

Provides mounting for 110 and 66 blocks.  
Mounts to rear wall.

Contents: two 110/66 block mounting rails and 20 #10-24 x 1/2" screws



Catalog. No.	
<b>REK110</b>	

## Panel Bracket for FSP Adapter

Use with adapter panels (see page G11).  
Snap mounts into structured cabling enclosures.

Contents: bracket



Catalog. No.	
<b>NSOFSB</b>	

## IDF Mounting Bracket

Use with residential structured cabling modules shown on page T7 and with NSOFSB.

Contents: bracket



Catalog. No.	
<b>REKHS</b>	

## 20A Power Kit

Occupies left or right side of 1 rear panel space.

Contents: Hubbell surge-protected duplex receptacle with audible alarm (HBL5262IS), single-gang work box, 6' Hubbell POLYTUFF® non-metallic conduit, stainless steel face plate, and assembly hardware kit



Catalog. No.	
<b>REKP</b>	

## Fiber Optic Bracket

Accepts one fiber FSP adapter panel.  
Occupies no rear panel spaces.

Contents: fiber optic bracket



Catalog. No.	
<b>REKFP</b>	

## MT10 Adapter

Mates PS3 large capacity, 3-channel, surface raceway to the top of **RE-BOX®** cabinets.  
Routes both electrical and communications cables.

Contents: base, cover and cover hardware kit

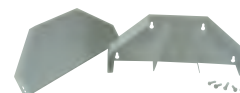

Catalog. No.	
<b>REKMT10</b>	