



# Quam

## ENCLOSURES

# SE9W

## SURFACE MOUNT

Enclosure for C5/BU/CK1/S or C5/BU/CK1/D  
Clock Baffle Assembly

### GENERAL DESCRIPTION

The **SE9W** is a 2-3/4" deep, surface mount, steel enclosure for the Quam C5/BU/CK1/S or C5/BU/CK1/D clock baffle assembly (supplied separately). White powder coat finish.

### INTENDED USE - Indoor Environment

**Surface Mount Installation** | Horizontal or Vertical Alignment

### MECHANICAL SPECIFICATIONS

<b>Clock Baffle Attachment</b>	4X #8-32 Threaded Hole
<b>Access to Surface</b>	1X #10 Keyhole Slots 3X #10 holes
<b>Electrical Access</b>	4" x 4" in Center of Enclosure 4X Wiremold Knockout

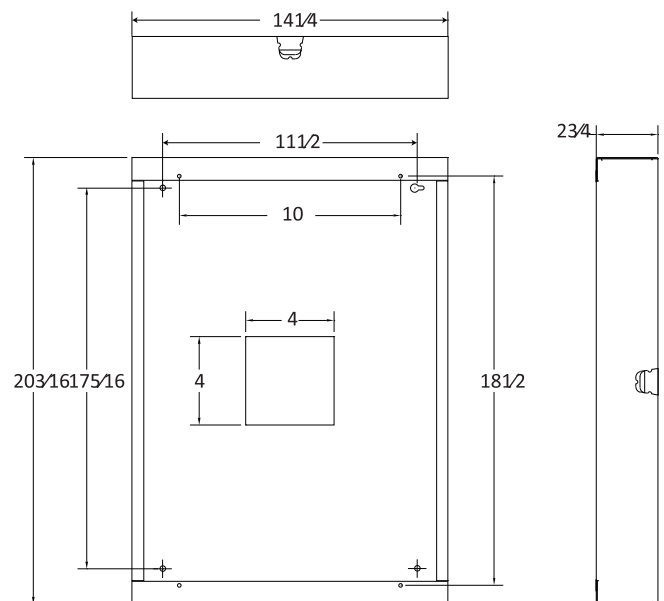

Recommended construction sequences, installation instructions, and A&E Specifications are available in various formats in the QUAM Architects' and Engineers' Resources section on the web at:  
[www.QuamSpeakers.com](http://www.QuamSpeakers.com)

© 2013 Quam-Nichols Company reserves the right to make changes and/or improvements to its products at any time and without notice.



QUAM-NICHOLS COMPANY, INC.  
234 East Marquette Rd.  
Chicago, IL. 60637  
Tel: 1-800-NEED-NOW (800-633-3669)  
Fax: 1-888-NEED-NOW (888-633-3669)  
e-mail: [NeedNow@QNC.com](mailto:NeedNow@QNC.com)  
[www.QuamSpeakers.com](http://www.QuamSpeakers.com)