

Universal Door Strike

SD-996C-NUQ

12/24 VDC, Fail-Safe or Fail-Secure

The **SECO-LARM®** Universal Door Strike can be used with virtually any cylindrical-locking system and can be configured for use in wood, aluminum, or metal doors. Included are three different-sized faceplates that can be easily installed on the strike to match the specific type of door frame.

Features:

- Includes 3 faceplates for nearly any door type
- UL 1304 Burglary
- Field-selectable for fail-safe or fail-secure operation
- Field-selectable dual-voltage 12/24 VDC operation
- Powered by a solenoid
- Reversible non-handed design fits either right-hand or left-hand doors
- Low profile: Strike is only 1 1/4" deep for use with hollow aluminum frames
- Includes trim plate to hide gaps in installation
- Optional lip-extension brackets available:
 - SD-995C-LE25 – 1" Extension
 - SD-995C-LE50 – 2" Extension

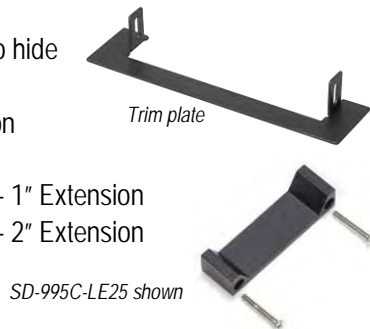

Specifications:

Model	SD-996C-NUQ	
Operating voltage	12 or 24 VDC ± 15%	
Current draw	12VDC	280mA@12VDC
	24VDC	140mA@24VDC
Operating temperature	14°~113° F (-10°~45° C)	
Operating humidity	85% ± 15%	
Jaw strength	2,000-lb	
Dimensions	Aluminum	4 7/8"x1 1/4" (124x32 mm)
	Hollow metal	4 7/8"x1 1/4" (124x32 mm)
	Wood	7 15/16"x1 7/16" (202x37 mm)



Power Connector
for easier
installation

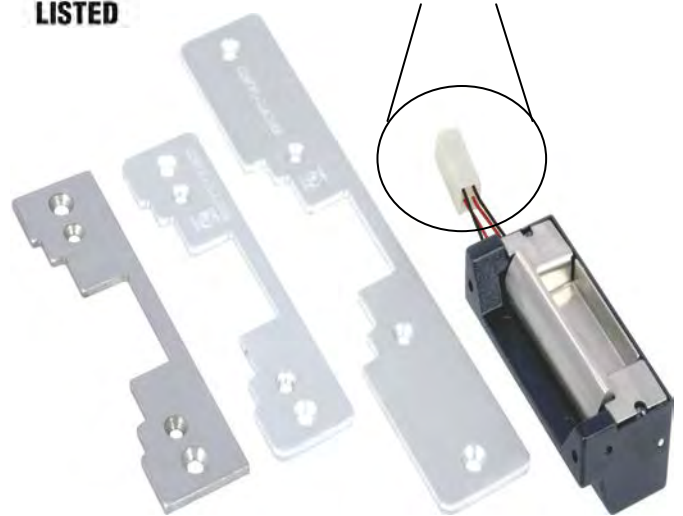

Also Available from **SECO-LARM®**:



SD-995C
SD-995C24
Electric Door Strike
for Metal Doors



SD-995C
SD-995C24
Electric Door Strike
for Wood Doors

SECO-LARM® U.S.A., Inc.

16842 Millikan Avenue, Irvine, CA 92606

Phone: (949) 261-2999 | (800) 662-0800 Fax: (949) 261-7326

Website: www.seco-larm.com Email: sales@seco-larm.com



Copyright 2015 © SECO-LARM U.S.A., Inc. All rights reserved.
All trademarks are the property of SECO-LARM U.S.A., Inc. or their respective owners.
The SECO-LARM policy is one of continual development. For that reason, SECO-LARM reserves the right to change prices and specifications without notice. SECO-LARM is not responsible for misprints.

SECO-LARM® ENFORCER® CRIMEBUSTER® CBA SLI®

PISD-996C-NUQ_151006.docx