



HT600

70.7V Line Transformer



HT600

Features

- Constructed Using Audio Grade Laminations
- Frequency Response is 30Hz - 15KHz
- High Power Handling
- High Quality Matching Transformer with Only 2dB Insertion Loss
- Primary Taps of 150, 300, & 600-Watts
- Secondary Outputs Offer Both 4Ω & 8Ω Impedance

General Description

The HT600 is a high power-handling transformer with minimal insertion loss and wide frequency response that provides quality line matching of loudspeakers in high power sound systems. The unit is constructed using audio grade laminations and offers primary taps at 150, 300, and 600-watts with secondary impedance settings for 4Ω and 8Ω. Insertion loss does not exceed 2dB and operates within a frequency range of +1dB from 30Hz – 15kHz. The transformer is designed for external mounting to surfaces other than the loudspeaker.

Applications

The Atlas Sound HT600 can be used in high SPL speaker systems where the speaker is located far from the amplifier allowing the use of smaller gauge wire with less line loss. Applications include shopping centers, convention centers, manufacturing facilities, military installations.

Specification

Frequency Response	30Hz - 15KHz
Power Taps	150, 300 & 600 Watts
Power Rating	600W
Primary Voltage	70.7V
Height	3.08" (7.82cm)
Width	3.785" (9.61cm)
Depth	3.49" (8.86cm)
Shipping Weight	6.218 lbs (2.83kgs)

Architect and Engineer Specifications

The transformer shall be Atlas Sound Model HT600 and shall be capable of delivering its full rated power within +/- 2dB from 30Hz - 15kHz. The primary power taps shall be 150, 300, and 600-watts. The secondary impedance shall be 4Ω and 8Ω. The insertion loss shall not exceed 2dB. The transformer shall be designed for 70.7V speaker lines.

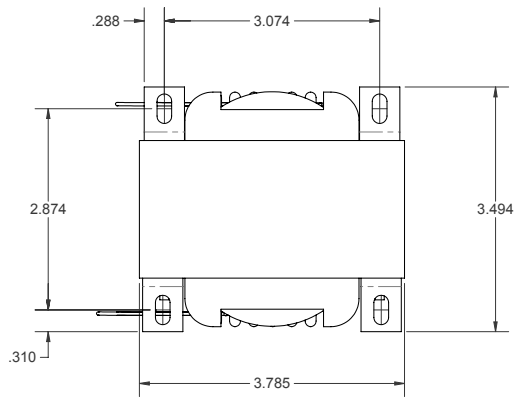

BOTTOM VIEW

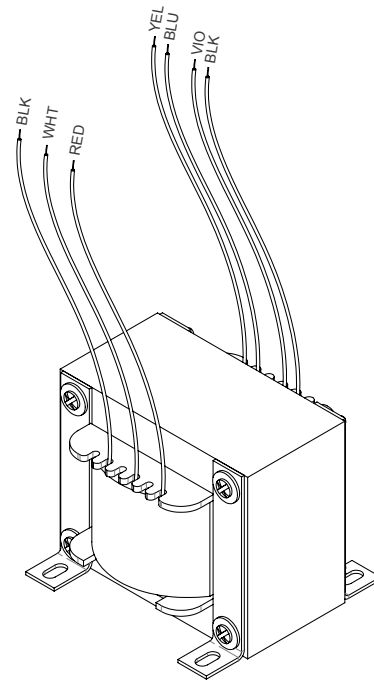

ISO VIEW

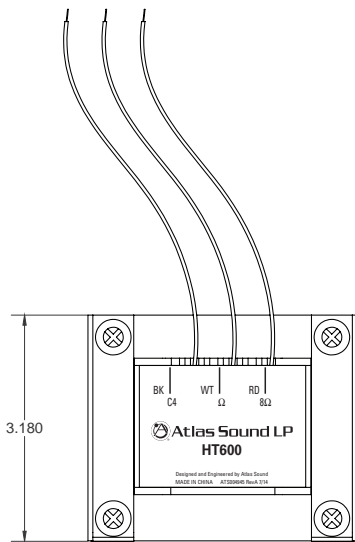

FRONT VIEW

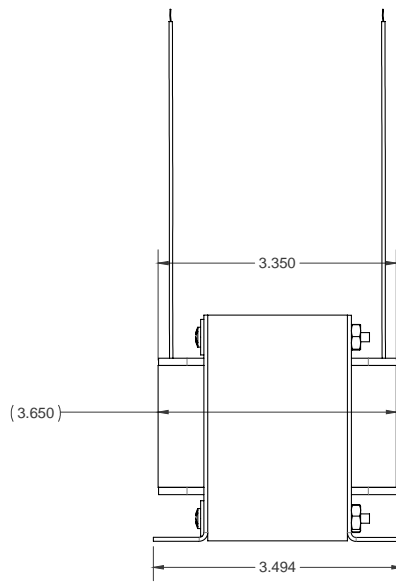

SIDE VIEW

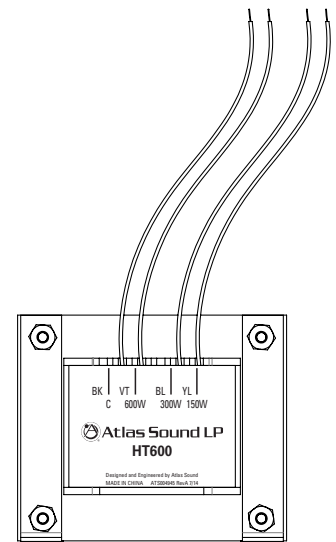

BACK VIEW

LABEL
NOTE: ARTWORK PER AT5004945

LABEL FOR SIZE REFERENCE ONLY

LABEL
NOTE: ARTWORK PER AT5004945