

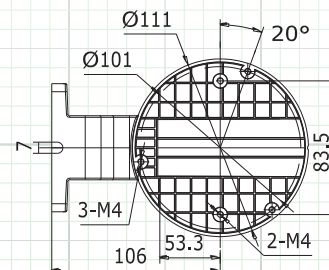

**IP4D4MM**

The diagram shows a microchip with a magnified view of its internal structure. The magnified view reveals a grid of memory cells, each containing a small square representing a bit of data. The grid is organized into rows and columns, with a central horizontal strip of larger cells. The magnified view is labeled with 'a' through 'f' to indicate specific components or data points.

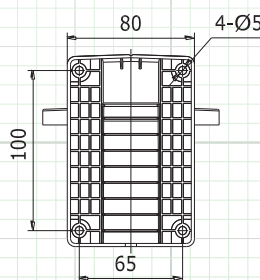
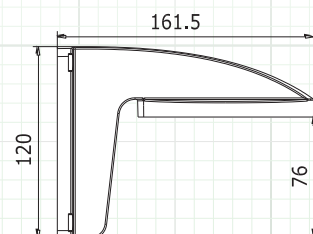

	SPECIFICATION	WMT110
	Color	White
	Application	Indoor Dome Camera Wall Mount
	Construction	ABS+PC
	Dimensions	111 mm × 120 mm × 161.5 mm
	Weight	200g

A detailed line drawing of a door lock assembly. It shows the internal mechanism, including the cylinder, bolt, and handle. A screw is shown being inserted into the handle to secure it. The diagram is labeled with 'screw' and 'door'.

A technical diagram of a butterfly clamp mechanism. It shows a vertical plate with a horizontal arm extending from it. The arm is connected to a circular component with a textured, gear-like surface. A curved arrow indicates the rotation of this component. The text "butterfly clamp" is written next to the circular part.