

## NetWay4EWPN 4-port PoE+ Hardened Switch

### Description

Altronix NetWay4EWPN Outdoor PoE+ Hardened Switch provides a 1Gb SFP port and four (4) PoE+ (30W) ports or up to two (2) Hi-PoE (60W) ports. Cameras/edge devices may be located up to 100m from the unit. Embedded LINQ Technology allows you to monitor, control, and report power and diagnostics from anywhere.



NetWay4EWPN

### Key Features

- Four (4) PoE/PoE+ (up to 30W) ports or two (2) Hi-PoE (60W) ports.
- External 48-55V UL Listed ITE power supply required.
- IEEE 802.3af (15W) and IEEE 802.3at (30W) compliant.
- One (1) Gigabit SFP port.
- NEMA4/4X, IP66 Rated enclosure for outdoor use.
- PoE activity LED indicators.
- UL Listed in the U.S. and Canada.
- CE Approved.

- Lifetime Warranty / Made in the U.S.A.

### Similar products:

- NetWay4EWPX - Outdoor 4-port PoE+ Hardened Switch in NEMA 4/4X, IP66-11 enclosure which accommodates stand-by batteries.
- NetWay4EWP - Outdoor 4-port PoE+ Hardened Switch in a NEMA 4/4X, IP66-11 enclosure.
- NetWay4EX - Indoor 4-port PoE+ Hardened Switch.
- NetWay4EPL - 4-port PoE+ Hardened Switch on Backplane.
- NetWay4EB - 4-port PoE+ Switch board only.

### Typical Applications

NetWay4EWPN  
Endspan

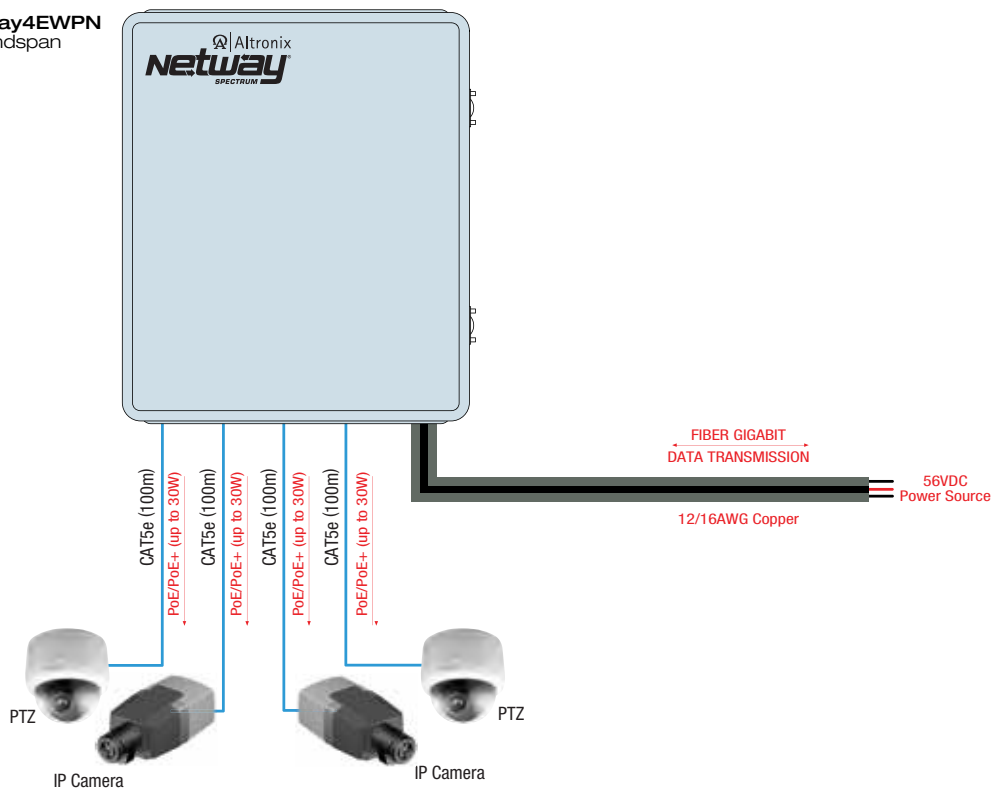

# NetWay4EWPN

## 4-port PoE+ Hardened Switch

### Specifications

#### Input

Voltage 48V-55V (UL Listed ITE power supply).

#### Output

Maximum Power Four (4) PoE+ (30W) ports or two (2) Hi-PoE (60W) ports. IEEE 802.3af (15W) and IEEE 802.3at (30W) compliant. 120W max power (external power supply required) Integral surge protection.

Fiber Port: One (1) Gigabit SFP port.

#### Indicators (LED)

Individual PoE On LEDs for each port.  
Individual IP Link status, 10/100Base-T/active LEDs for each port.  
ALOS LED indicates fiber connection for SFP port.  
Heartbeat LED indicates proper operation of the unit.

#### LINQ Technology:

Remote network management allows for camera/device reset and monitoring.  
Provides local and/or remote access to critical information via LAN/WAN.  
Email and Windows Dashboard Alert notifications report real-time diagnostics.  
Event log tracks history.

#### Agency Listings

UL/cUL UL60950-1 (Information Technology Equipment). UL60950-22 (Information Technology Equipment to be installed Outdoors). CE European Conformity.

#### Physical and Environmental

Enclosure Dimensions (H x W x D approx.): 13.31" x 11.31" x 5.59" (338.1mm x 287.3mm x 142mm). NEMA 4/4X, IP66-11 Rated enclosure for outdoor use.

#### Product Weight / Shipping (approx.)

Product Weight: 7.7 lbs. (3.49kg)

Shipping Weight: 10.0 lbs. (4.54kg)

#### Temperature

Operating (120W): -40°C to 75°C (-40°F to 167°F)

Storage: -40°C to 85°C (-40°F to 185°F)

Relative Humidity: 85% +/-5%.

Operating Altitude: -304.8 to 2,000m.

### Accessories



#### NetWaySP1A - Ethernet over Fiber Media Converter/Repeater

*For Applications requiring an additional SFP (Fiber) Port*

NetWaySP1A PoE powered media converter/repeater converts 10/100/1000 Mbps to Fiber (1000Base-X/SX/LX).



#### P1MM and P1SM10 - SFP Modules

Altronix P1MM and P1SM10 are hot-pluggable SFP fiber transceiver modules and are readily usable with all Altronix Spectrum fiber optic equipment for 1G transmission rates. The P1MM is to be used with Multi-Mode Fiber for distances up to 550m. The P1SM10 is to be used with Single-Mode Fiber for distances up to 10Km.

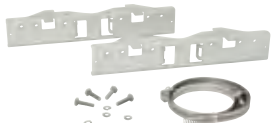

#### PMK1 Pole Mount Kit (order separately)

PMK1 pole mount kit is designed to simplify installation of outdoor units. It accommodates 2" - 8"(diameter) poles.