

Miller Tripod Models 51 and 51X

Description_____

The Miller 51 and 51X Tripods are the anchorage connector for typical confined space and rescue systems. The lightweight, high-strength aluminum construction can withstand up to 5,000 lbs. (22kN) of vertical pull. The adjustable legs with integral push pins can easily adapt to uneven surfaces. The built-in safety chain and feet with rubber skid pads and serrated edge prevent movement on slippery surfaces.

Model 51 is 7' (2m) high and the 51X is 9' (2.7m) with the legs extended to the highest position.

Both models have a center anchorage eyebolt and a side eyebolt anchorage on the cap. The center anchorage should always be used for fall protection with the side eyebolt being used for hoisting/lifting of materials or workers.

Materials

Tripod Cap	Aluminum
Legs	Aluminum
Chain	Zinc Plated Steel
Feet	Aluminum & Rubber
Minimum Tensile Strength	5,000 lbf. (22kN)
Increments of Leg Adjustment	5.5" (13.97mm)

All hardware meets ASTM (50) fifty-hour salt spray test requirements.

Technical

Weight:

Model 51	32 lbs. (14.5 kg)
Model 51X	42 lbs. (19.1 kg)
Max Working Load (U.S.)	400 lbs. (181.4 kg)
Max Working Load (EN795)	1100 lbs. (500 kg)
Max Materials Load (U.S.)	1,000 lbs. (453.6 kg)

Certification

ANSI Z359.1
OSHA 1926.502
CE0333 – EN795 class B (Model 51 only)

Identification

Label Materials.....Valeron
Label Contents.....Inspection, Type, Model,
Date, Warnings, Certifications.



The following chart represents the height of the tripod in relation to the diameter of the tripod bottom and the working area available. The increments shown do not match the actual positions on the tripod.

Tripod Height	Diameter
108" (51X only)	90"
96" (51X only)	80"
84"	70"
72"	60"
60"	50"
48"	40"



by Honeywell

Toll Free 800.873.5242 (press 4) • hsptechsupport@honeywell.com • www.millerfallprotection.com

WARNING! THIS DOCUMENT PROVIDES AN OVERVIEW OF FALL PROTECTION **PRODUCTS** AVAILABLE FROM HONEYWELL AND CARE HAS BEEN TAKEN TO ASSURE THE ACCURACY OF THE DATA. IT DOES NOT PROVIDE IMPORTANT PRODUCT WARNINGS AND INSTRUCTIONS. HONEYWELL RECOMMENDS ALL USERS OF FALL PROTECTION EQUIPMENT UNDERGO THOROUGH TRAINING, AND THAT ALL WARNINGS AND INSTRUCTIONS PROVIDED WITH THE PRODUCTS BE THOROUGHLY READ AND UNDERSTOOD PRIOR TO EACH USE. FAILURE TO READ AND FOLLOW ALL PRODUCT WARNINGS AND INSTRUCTIONS COULD RESULT IN SERIOUS INJURY OR DEATH.

17D-1 Carabiner

Description

Miller twist lock carabiners with spring loaded keepers are used as anchorage connectors. The 17D-1 has a 1" gate opening, and is plated to resist rust and corrosion.

Materials

Carabiners: Zinc Dichromate Plated
Forged Alloy Steel

Technical

Proof Tested: 3,600 lbs (16kN)

Min Tensile Strength: 5,000 lbs (22.2kN)

Max Working Load: 400 lbs (181kg)

Weight: 8.0 oz.

Certification

Meets or exceeds OSHA 1926.502, ANSI Z359-2007 and CSA Z259.12 requirements.

*ANSI Z359-2007 compliant for connectors which meet the 3,600lb gate requirements.

Warning!

Carabiner must be closed and locked prior to use. Inspect before each use. Improper use could result in serious injury or death.

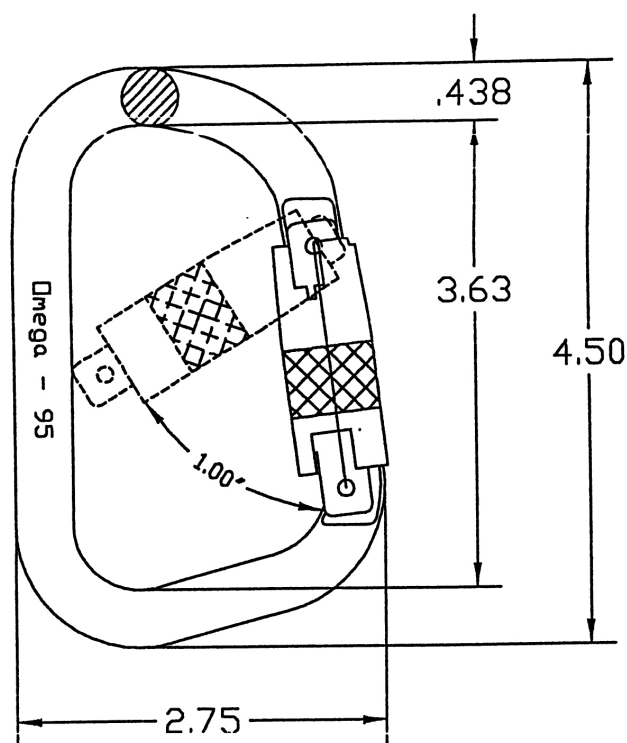

MILLER
by SPERIAN

Toll Free 800-873-5242 • Phone 814.432.2118 • Fax 814.437.2973 • www.millerfallprotection.com

WARNING! THIS DOCUMENT PROVIDES AN OVERVIEW OF FALL PROTECTION PRODUCTS AVAILABLE FROM MILLER FALL PROTECTION AND CARE HAS BEEN TAKEN TO ASSURE THE ACCURACY OF THE DATA. IT DOES NOT PROVIDE IMPORTANT PRODUCT WARNINGS AND INSTRUCTIONS. MILLER FALL PROTECTION RECOMMENDS ALL USERS OF FALL PROTECTION EQUIPMENT UNDERGO THOROUGH TRAINING, AND THAT ALL WARNINGS AND INSTRUCTIONS PROVIDED WITH THE PRODUCTS BE THOROUGHLY READ AND UNDERSTOOD PRIOR TO EACH USE. FAILURE TO READ AND FOLLOW ALL PRODUCT WARNINGS AND INSTRUCTIONS COULD RESULT IN SERIOUS INJURY OR DEATH.

Miller® ManHandler™ Hoist

Model: 8442/65FT, 8442-Z7/65/FT, 8442/100FT, 8442-Z7/100FT

Description

The Miller® ManHandler™ Hoist is the perfect solution for a range of applications including confined space entry, rescue, positioning and personnel/material handling. A secondary fall arrest system is recommended for fall protection.

Models are available with stainless steel wire rope by adding "SS" after model number (Ex: 8442SS/65FT)

Materials

Housing:	Steel, Yellow Chromate Plating (Zinc)
Drum:	Steel Weldment, Yellow Chromate Plating (Zinc)
Shaft:	4140 Steel
Springs:	Stainless Steel
Brake Pawls:	Stainless Steel
Brake Pads:	Fiber Composite
Bearings:	Oil Impregnated Bronze
Hardware:	Grade 5, Zinc Plated
Snap Hook:	Drop Forged Steel
Cable:	3/16" galvanized steel or stainless steel

Technical

Maximum Working Load:	350lbs (159kg)
Brake Systems:	Holding and Inertia – friction disk
Gear Ratio:	5:1
Retrieval Speed:	20ft/min
Length:	65ft (20m), 100ft (30.5m)
Weight (65FT):	39lbs (18kg)
Weight (100FT):	41.275lbs (19kg)

Certification

8442/65FT and 8442/100FT: Meets OSHA 1910.146 and ANSI Z117.1 requirements.

8442-Z7/65FT and 8442-Z7/100FT: ANSI Z359-2007 compliant for connectors which meet the 3600lb gate requirements, ANSI Z117.1, and OSHA 1910.146 requirements.



Warnings & Limitations

- Users must read, understand and follow all instructions.
- Only trained personnel should use this device.
- Do not use the unit if any part of the system appears to be damaged.
- Do not attempt to service this unit. If it does not operate properly or needs repair, return the unit to Miller for service.
- The designed working load limit is 350 pounds. Do not exceed the working load.
- Except when used as an emergency rescue device, independent fall protection must be used in conjunction with this unit to raise, lower or suspend personnel.
- When winch cable is attached to a workers harness, the cable must be free of slack and remain taut.
- See operation and instruction manual for proper mounting procedures. Applications requiring the use of a personal fall arrest system must be capable of supporting 5,000lbs.

Miller® ManHandler™ Hoist

Model: 8442/65FT, 8442-Z7/65/FT, 8442/100FT, 8442-Z7/100FT

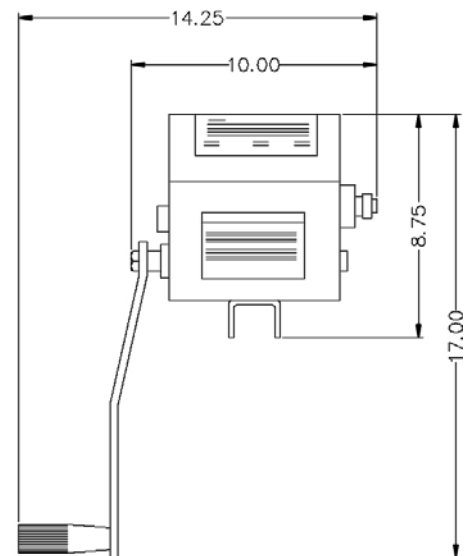
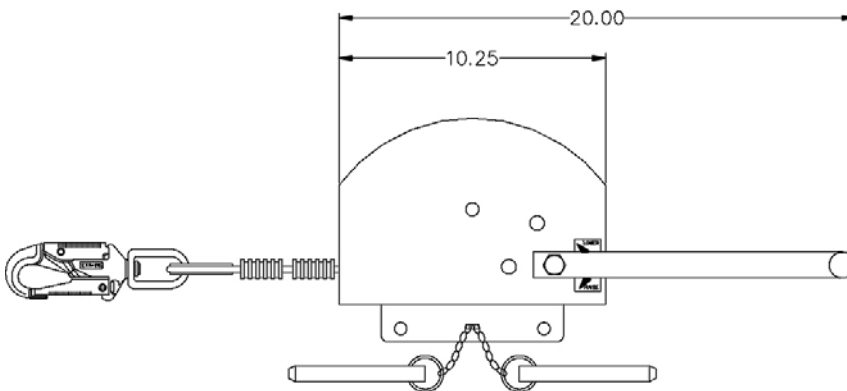
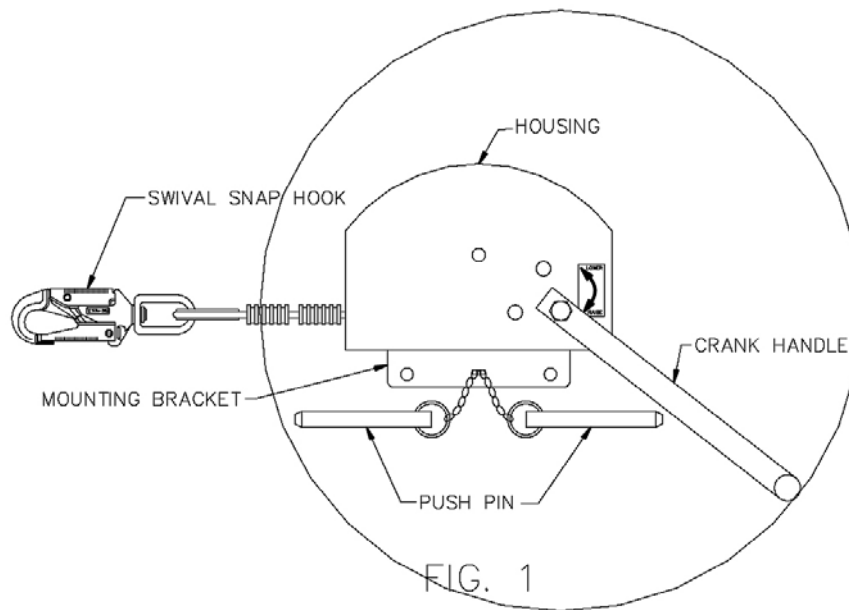

by Honeywell

Toll Free 800.873.5242 (press 4) • hsptechsupport@honeywell.com • www.millerfallprotection.com

⚠ WARNING! THIS DOCUMENT PROVIDES AN OVERVIEW OF FALL PROTECTION PRODUCTS AVAILABLE FROM HONEYWELL AND CARE HAS BEEN TAKEN TO ASSURE THE ACCURACY OF THE DATA. IT DOES NOT PROVIDE IMPORTANT PRODUCT WARNINGS AND INSTRUCTIONS. HONEYWELL RECOMMENDS ALL USERS OF FALL PROTECTION EQUIPMENT UNDERGO THOROUGH TRAINING, AND THAT ALL WARNINGS AND INSTRUCTIONS PROVIDED WITH THE PRODUCTS BE THOROUGHLY READ AND UNDERSTOOD PRIOR TO EACH USE. FAILURE TO READ AND FOLLOW ALL PRODUCT WARNINGS AND INSTRUCTIONS COULD RESULT IN SERIOUS INJURY OR DEATH.

MIGHTEVAC™+

TECHNICAL DATA

SP100 Rev. F

Jun. 2024

The Honeywell Miller **MightEvac™+** combines the performance and reliability of the MightyLite™+ Self-Retracting Device Serie with a quick-activating retrieval mechanism for emergency evacuation.

MATERIALS

Housing:	Aluminum Alloy, Stainless
Drum:	Aluminum Alloy, Stainless
Mainspring:	Stainless Steel / Carbon Steel
Break Pawls:	Stainless Steel
Main Shaft:	Stainless Steel
Bushing:	Ball & Roller Bearing

TECHNICAL

Min. Working Capacity:	130 lb (59 kg)
Max. Working Capacity:	See table below for capacity ratings
Working Length Capacity:	50 ft (15 m), 100 ft (30 m)
Max. Arrest Distance:	42 in (1.06 m) (when tested to ANSI Z359.14)
Avg. Arresting Force:	1350 lb (6 kN) (when tested to ANSI Z359.14)
Max. Peak Arresting Force:	1,800 lb (8 kN) (when tested to ANSI Z359.14)

CERTIFICATION

Meets requirements of OSHA 1926.502, 1910.140.
Certified ANSI Z359.14-2021 SRL-R Class 1.

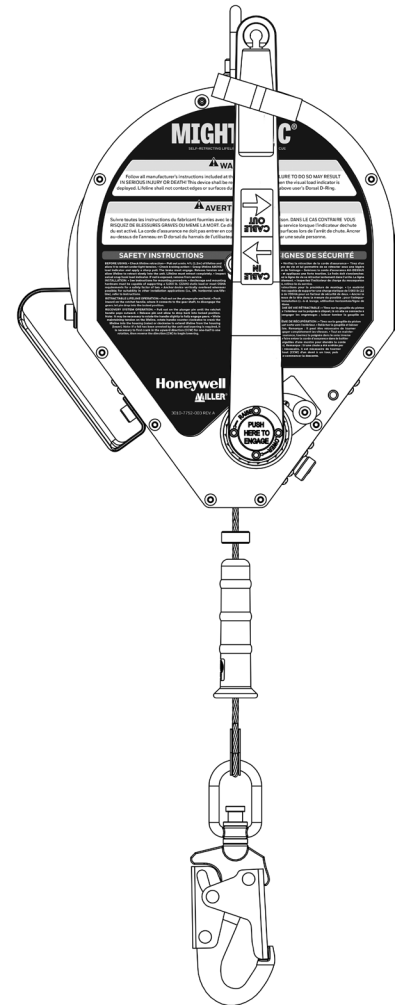

SKU	LENGTH	UNIT CONNECTOR	TRIPOD BRACKET	LIFELINE CONNECTOR	WEIGHT	MAX. WORKING CAPACITY	
						ANSI	OSHA
LIFELINE GALVANIZED STEEL							
MME-GCB1-02/50FT	50 ft	Steel Carabiner	✓	Load indicator steel snap hook w/swivel	37.5 kg (17 kg)	310 lb (141 kg)	420 lb (190.5 kg)
MME-OGC1-02/50FT	50 ft	Steel Carabiner		Load indicator steel snap hook w/swivel	28.7 lb (13 kg)	310 lb (141 kg)	420 lb (190.5 kg)
MME-GCB1-02/100FT	100 ft	Steel Carabiner	✓	Load indicator steel snap hook w/swivel	54.2 lb (24.5 kg)	310 lb (141 kg)	420 lb (190.5 kg)
MME-OGC1-02/100FT	100 ft	Steel Carabiner		Load indicator steel snap hook w/swivel	45 lb (20.4 kg)	310 lb (141 kg)	420 lb (190.5 kg)
LIFELINE STAINLESS STEEL							
MME-OSS1-01/50FT	50 ft	Steel Carabiner		Load indicator steel snap hook w/swivel	37 lb (16.8 kg)	310 lb (141 kg)	420 lb (190.5 kg)
MME-SCB1-01/50FT	50 ft	Steel Carabiner	✓	Load indicator steel snap hook w/swivel	42.3 lb (19.2 kg)	310 lb (141 kg)	420 lb (190.5 kg)
MME-OSS1-01/100FT	100 ft	Steel Carabiner		Load indicator steel snap hook w/swivel	54.2 lb (24.6 kg)	310 lb (141 kg)	420 lb (190.5 kg)
MME-SCB1-01/100FT	100 ft	Steel Carabiner	✓	Load indicator steel snap hook w/swivel	63 lb (28.5 kg)	310 lb (141 kg)	420 lb (190.5 kg)



Load indicator steel snap
hook w/swivel

Limitless Possibilities. Ask the Expert.
Technical Service: 800.873.5242
www.millerfallprotection.com

Honeywell Safety Products USA, Inc.
855 S Mint St
Charlotte, NC 28202
www.honeywell.com

USA
Phone: 800.430.5490
Fax: 800.322.1330

⚠ This equipment should only be used after reading and understanding the manufacturer's instructions. Failure to follow instructions could result in serious injury or fatality.

**THE
FUTURE
IS
WHAT
WE
MAKE IT**

Honeywell